

1 PORTAL - FACHADA
ESC 1:50

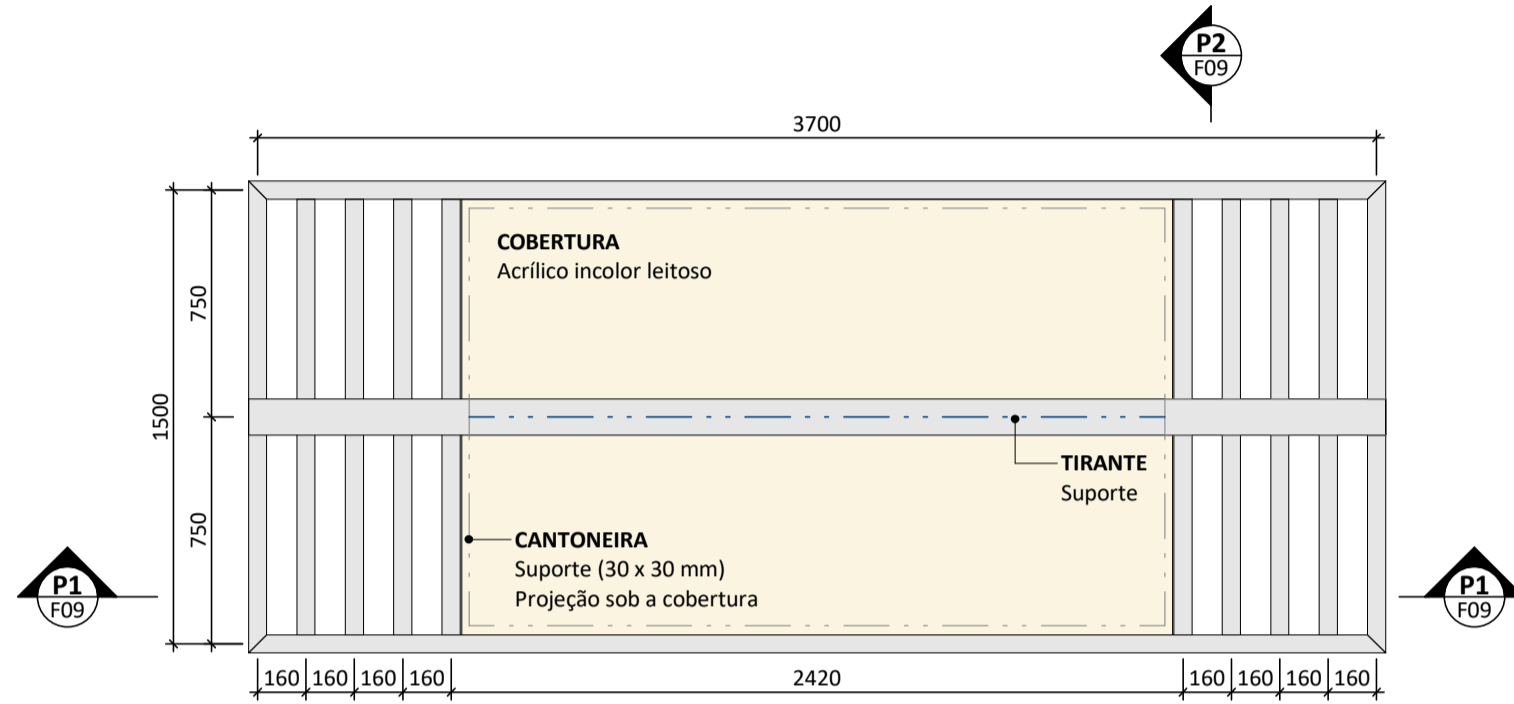

2 PORTAL - COBERTURA
ESC 1:25

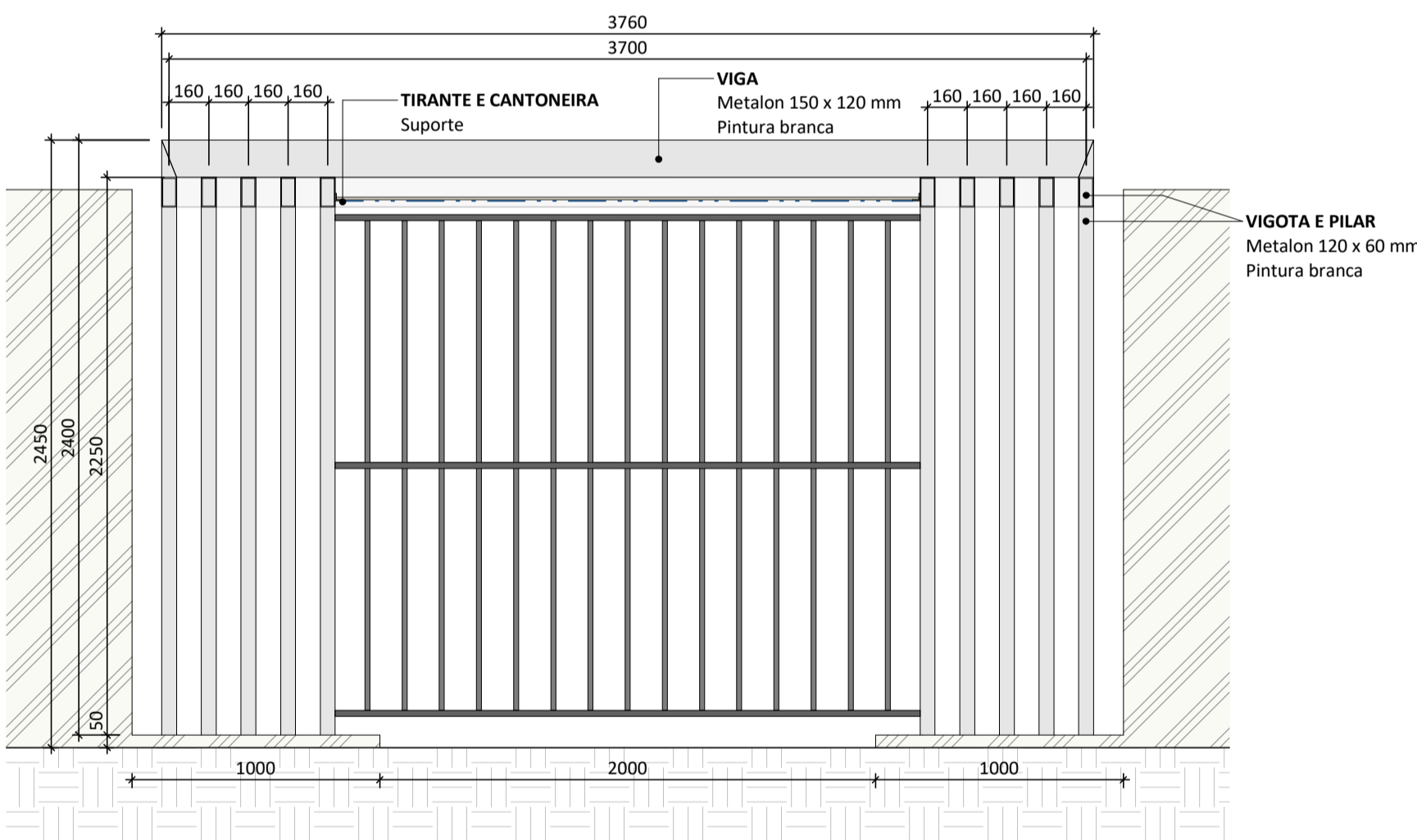

P1 PORTAL - CORTE - P1
ESC 1:25

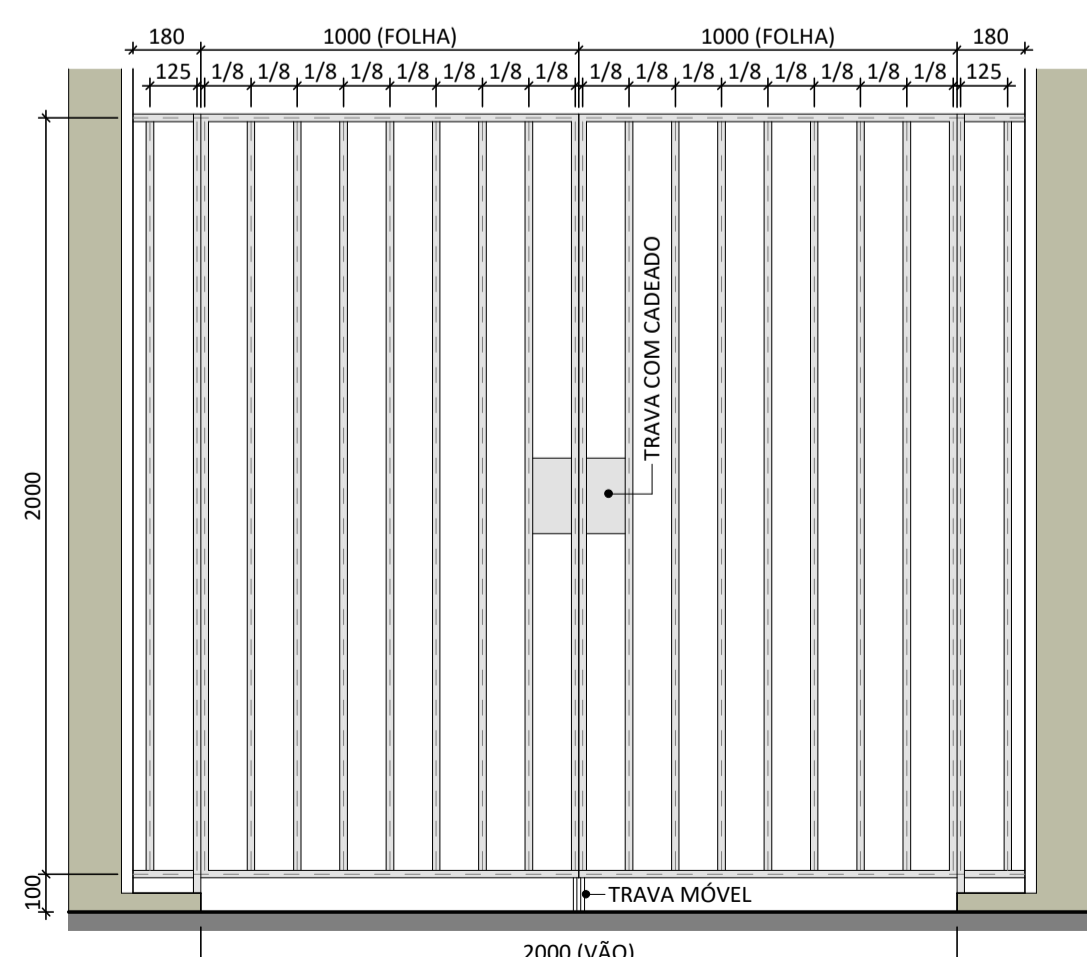

7 DETALHE - ESQUADRIAS
ESC 1:20

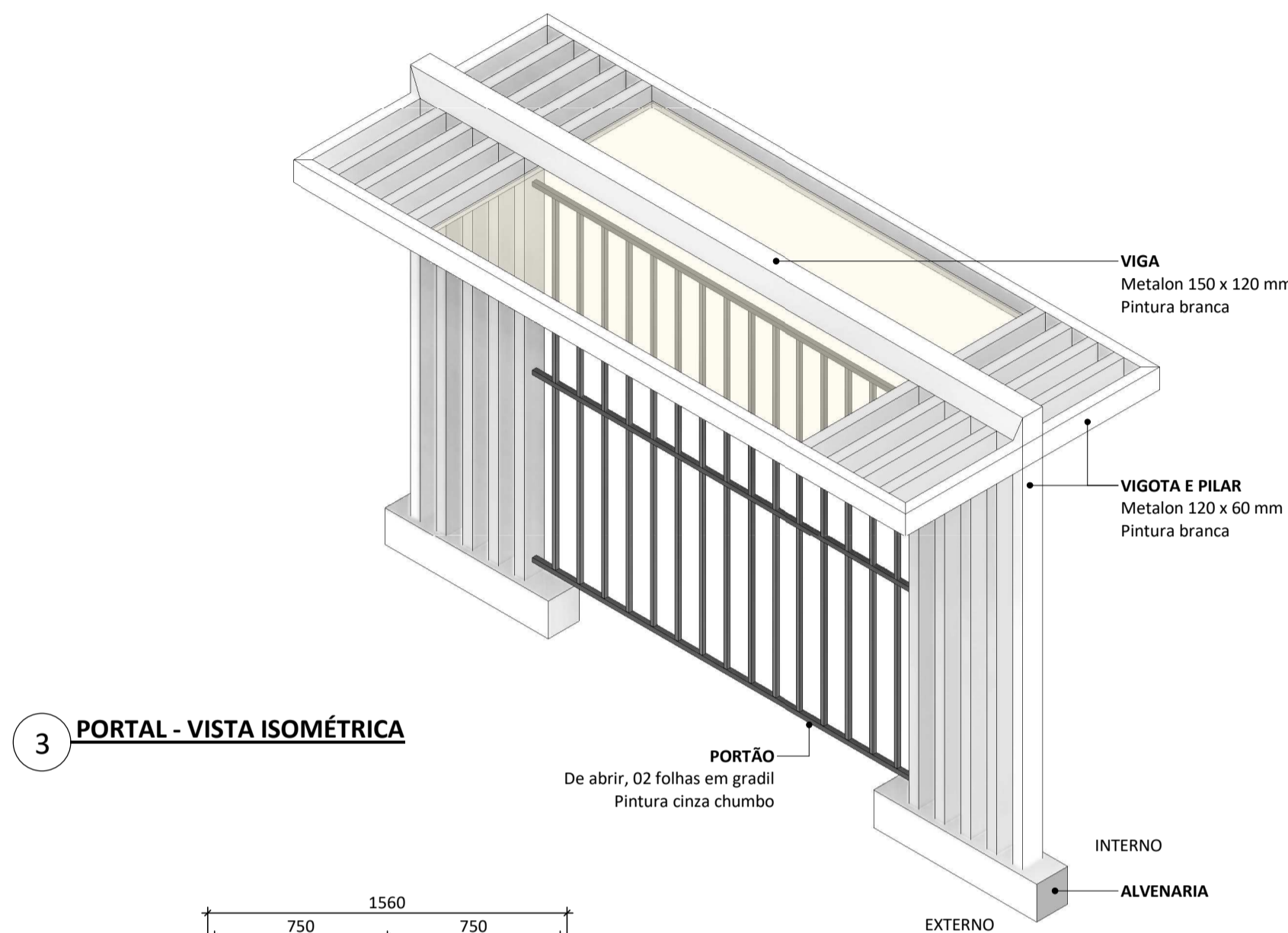

3 PORTAL - VISTA ISOMÉTRICA

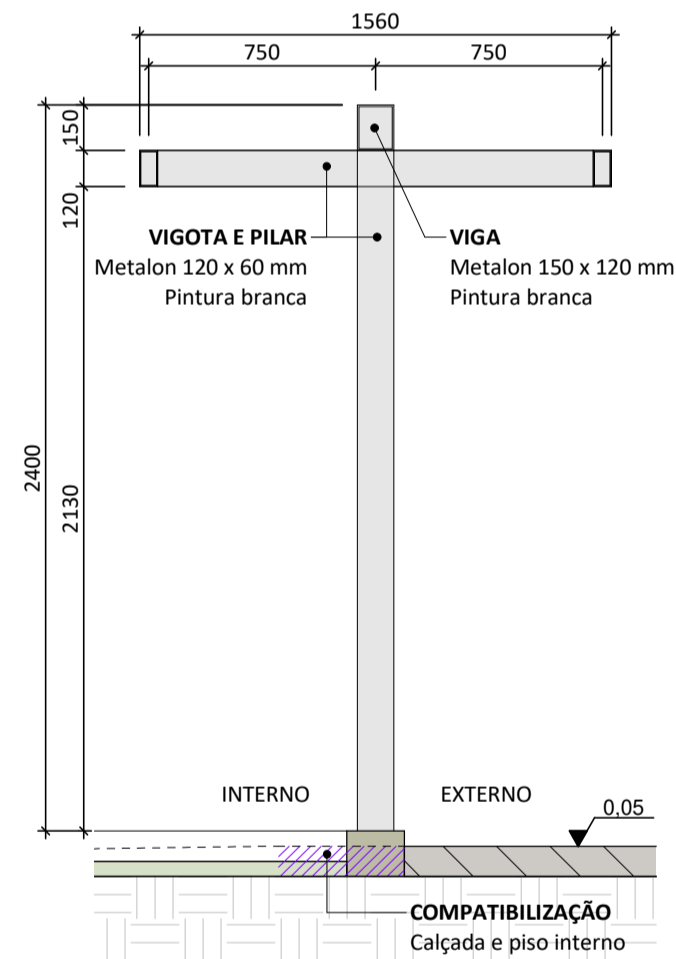

P2 PORTAL - CORTE - P2
ESC 1:25

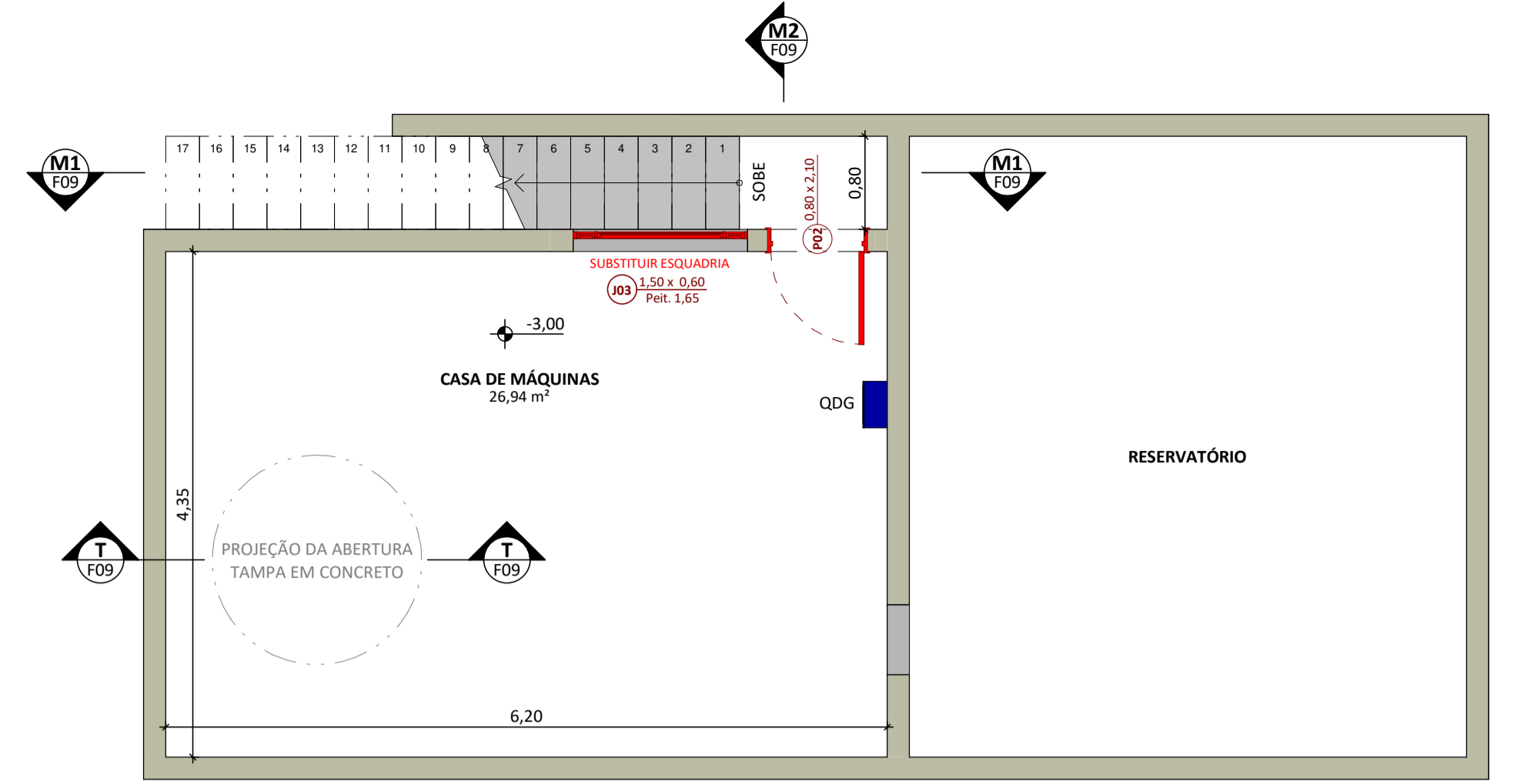

4 CASA DE MÁQUINAS - PLANTA BAIXA
ESC 1:50

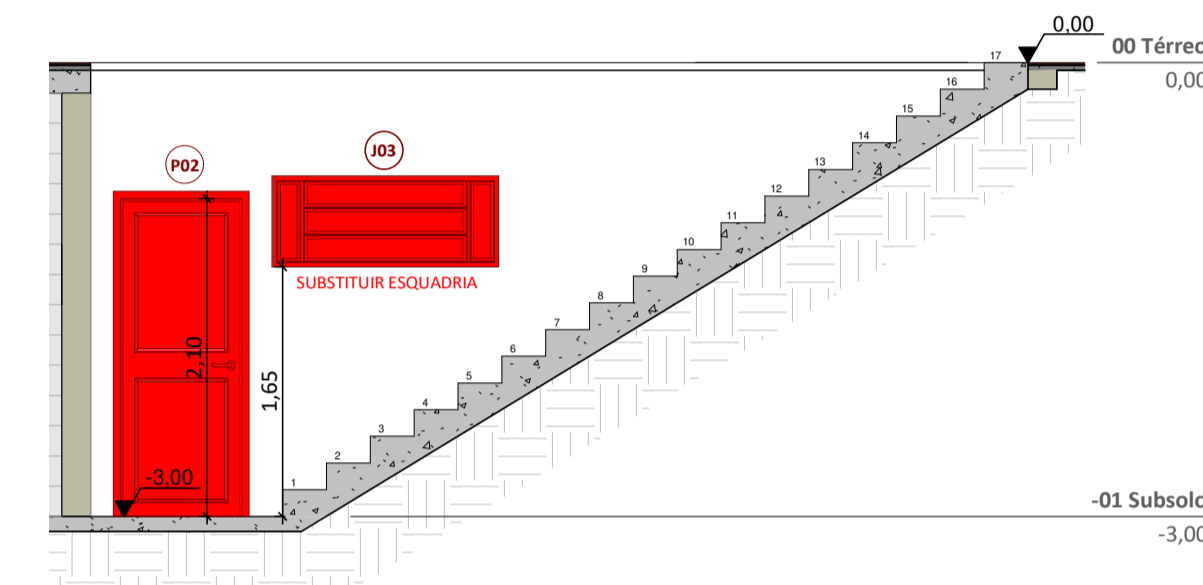

M1 CASA DE MÁQUINAS - CORTE - M1
ESC 1:50

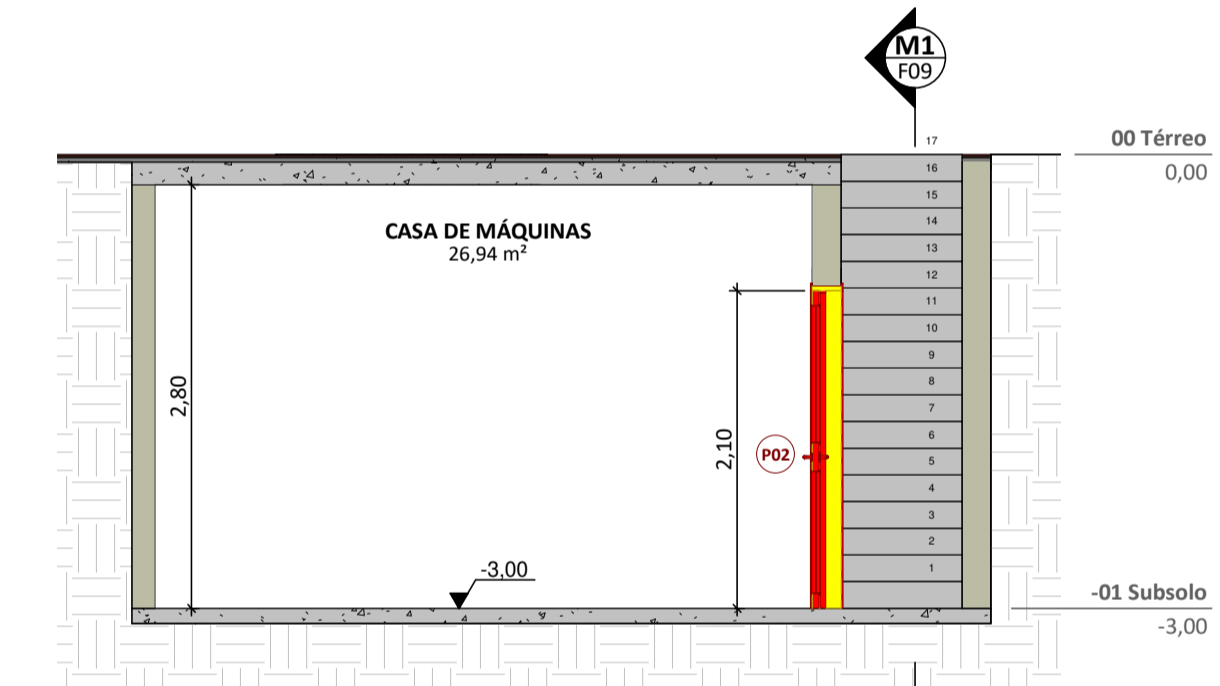

M2 CASA DE MÁQUINAS - CORTE - M2
ESC 1:50

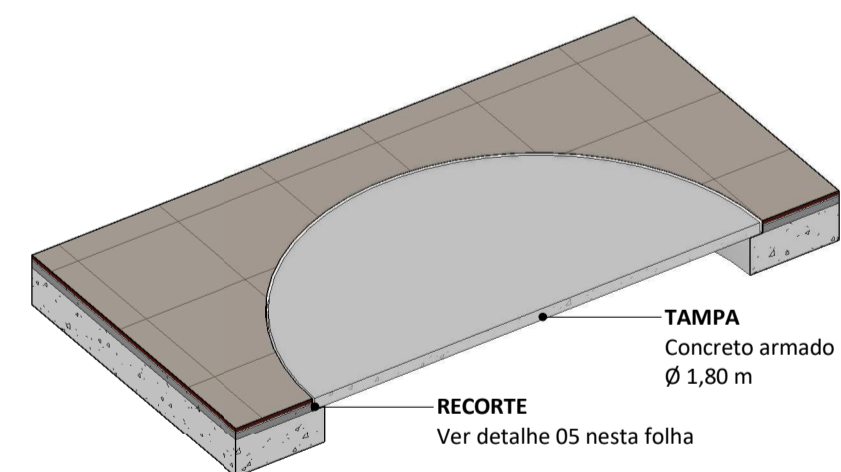

6 TAMPA DE CONCRETO - VISTA ISOMÉTRICA

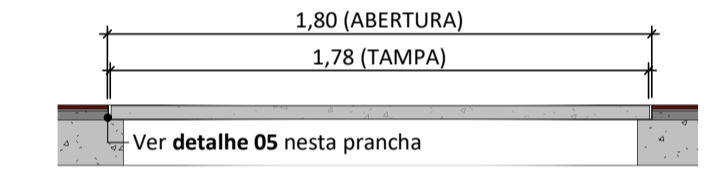

T TAMPA DE CONCRETO - CORTE
ESC 1:25

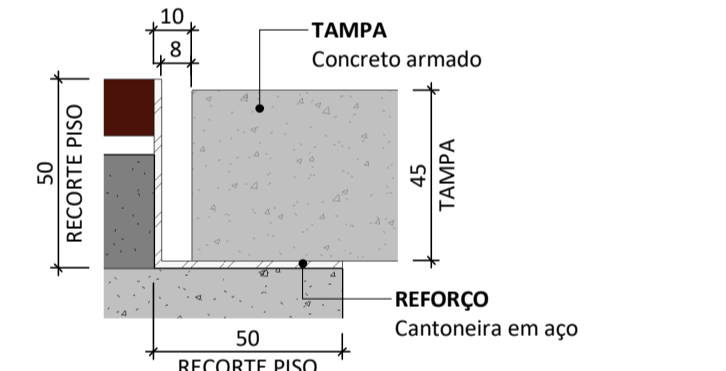

5 TAMPA DE CONCRETO - DETALHE
ESC 1:2 *dimensões em milímetros

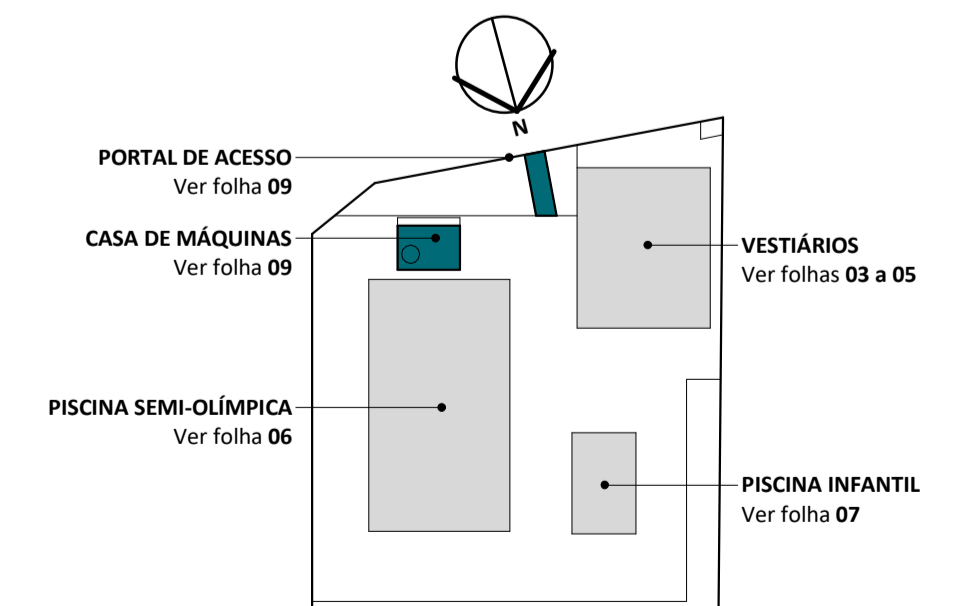

VISTO E ACEITO		EXECUTADO POR		PREFEITURA MUNICIPAL DE SANTA LÚCIA			
				PORTAL DE ACESSO CASA DE MÁQUINAS			
ANALISADO:	/ /	DES. José Luis Bertho Sobrinho	06/03/2019				
ACEITO:	/ /	PROJ. José Luis Bertho Sobrinho	06/03/2019				
VISTO:	/ /	APROVADO POR: José Luis Bertho Sobrinho					
		ASS. CREA 0641791972	06/03/2019	ESCALA	Como indicado	REV.:	00 FOLHA 09/11